

USE SPLIT HALF UNITS AT CORNERS (STANDARD UNITS SPLIT IN HALF)

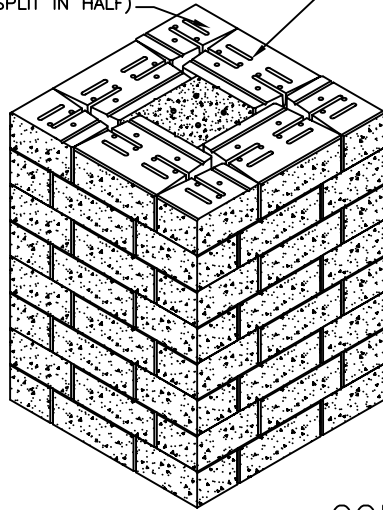

COLUMN CAP NOT SHOWN FOR CLARITY

COLUMN NOTES:
SEE COLUMN SECTION AND INSTALLATION SEQUENCE DRAWINGS FOR FURTHER DETAILS AND NOTES

COLUMN DETAIL

36" SQUARE COLUMN
SCALE: NONE

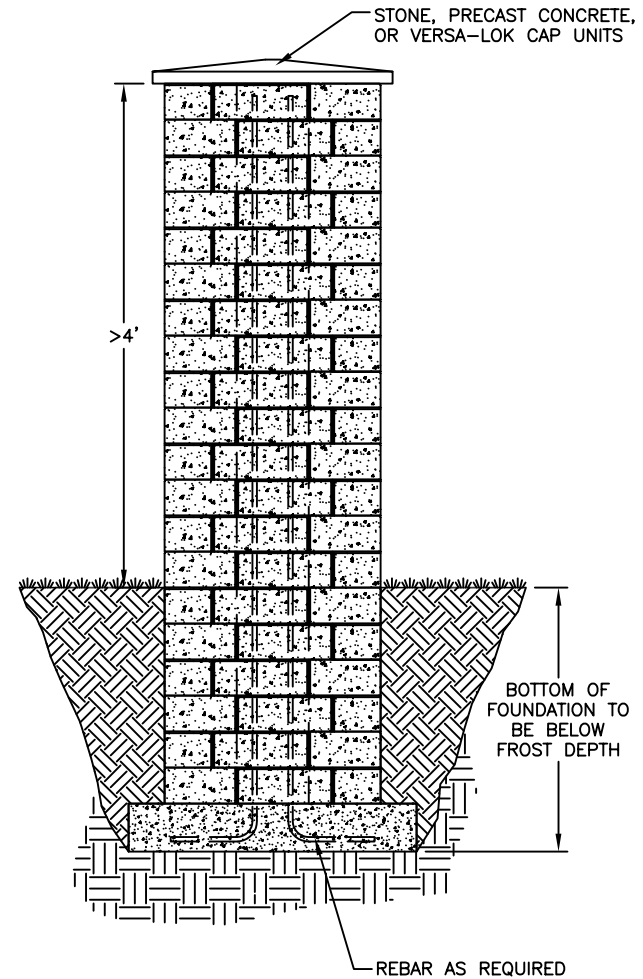

- REINFORCED COLUMN NOTES:
1. TEMPORARY BRACING MAY BE REQUIRED TO RESIST PRESSURES FROM THE WET CONCRETE PLACED ON THE VERSA-LOK UNITS DURING CONSTRUCTION
 2. CONCRETE FOUNDATION AND STEEL REINFORCEMENT SHOULD BE DESIGNED BY A QUALIFIED ENGINEER
 3. FOR ADDITIONAL INFORMATION ON COLUMNS -REFER TO TECHNICAL BULLETIN #6

CONCRETE ODD COURSE

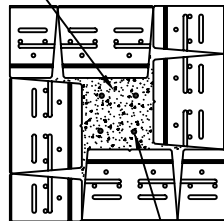

REBAR AS REQUIRED

EVEN COURSE

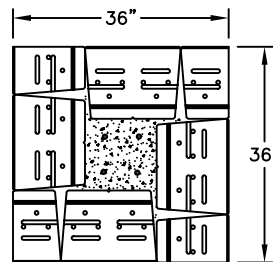

INSTALLATION SEQUENCE

REINFORCED COLUMN
SCALE: NONE

NOT FOR CONSTRUCTION

THESE PRELIMINARY DETAILS ARE INTENDED AS AN AID IN DESIGNING ATTRACTIVE, DURABLE RETAINING WALLS WITH VERSA-LOK STANDARD UNITS. FINAL DETERMINATION OF THE SUITABILITY OF ANY INFORMATION OR MATERIAL FOR THE USE CONTEMPLATED, AND ITS MANNER OF USE, IS THE SOLE RESPONSIBILITY OF THE USER. A FINAL PROJECT SPECIFIC DESIGN SHOULD BE PREPARED BY A QUALIFIED, LICENSED, PROFESSIONAL ENGINEER.

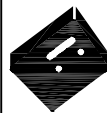

VERSA-LOK®
Retaining Wall Systems

(800)770-4525 fax(651)770-4089
6348 Hwy36 Ste1, Oakdale, MN 55128 **Solid Solutions™**

VERSA-LOK DETAILS

36 INCH REINFORCED COLUMN

SCALE:	AS NOTED
DRAWN BY:	PPS
CHECKED BY:	
DATE:	10/03
DWG. NO.	R18 36 INCH REINFORCED COLUMN